

) david
trubridge



Navicula



Navicula

Navicula is derived from nature, in this case from one of the many microscopic diatoms that float around in the worlds oceans. The flowing, segmented form is shipped as flatpack and assembled on site with push-in nylon clips. The thin curved pieces of CNC-cut bamboo plywood create a flowing structure that also casts magical patterns. It is lit from within with a row of LED pin-point lights. There are three sizes.

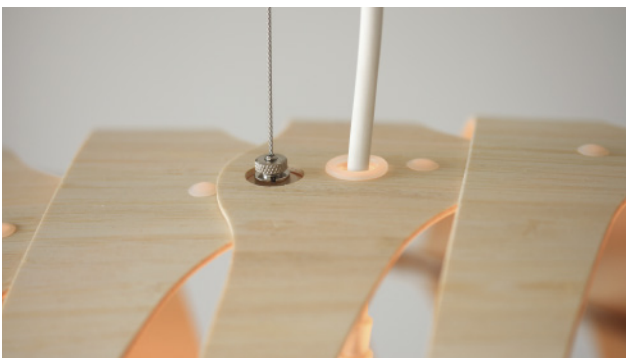

Features

Partially assembled Kitset

Our kitset lightshades are on average 1/30th of the volume of the assembled light. This aims to help minimize the effects of shipping and to reduce the design's environmental footprint.

Care Instructions

All wooden and/or polycarbonate lights are intended for use in dry interior conditions only and can be cleaned with a soft cloth or duster when the light is switched off. Do not use detergents.

Compliance

CE

AS/NZS

(Declarations of conformity available on request).

Warranty

This light is warranted for three years from date of purchase for failure of parts.



Technical Data

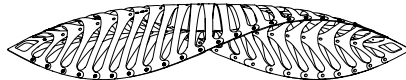
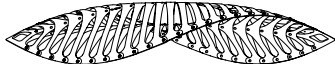
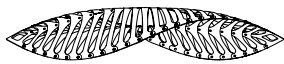

Small

Medium

Large

Dimensions

Width: 570mm / 22"
Height: 200mm / 8"
Length: 1440mm / 57"
Weight: 2kg / 4lb

Width: 900mm / 35"
Height: 380mm / 15"
Length: 1950mm / 77"
Weight: 3kg / 7lb

Width: 1000mm / 39"
Height: 450mm / 18"
Length: 2550mm / 100"
Weight: 6kg /14lb

Cordset

5m / 16.4ft

5m / 16.4ft

5m / 16.4ft

Material

Bamboo plywood
(Sourced from FSC accredited factory)

Bamboo plywood
(Sourced from FSC accredited factory)

Bamboo plywood
(Sourced from FSC accredited factory)

Fasteners

Nylon

Nylon

Nylon

Suspension

2 x Suspension Wires

2 x Suspension Wires

2 x Suspension Wires

Packaging

1130mm x 750mm x 90mm
44"x 30" x 4"
0.076m³ / 2.6839ft³
6kg / 13.22lb

1130mm x 750mm x 90mm
44"x 30" x 4"
0.076m³ / 2.6839ft³
7kg / 15.43lb

1280mm x 925mm x 130mm
50"x 36" x 5"
0.154m³ / 5.4384ft³
13kg / 28.66lb

You will need

Fixings for cone gripper (fixing screws NOT SUPPLIED).

Note: Choose appropriate hardware to attach base plate (Fig.1) to ceiling substrate.

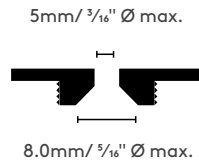
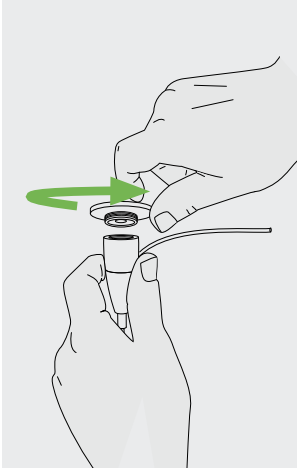
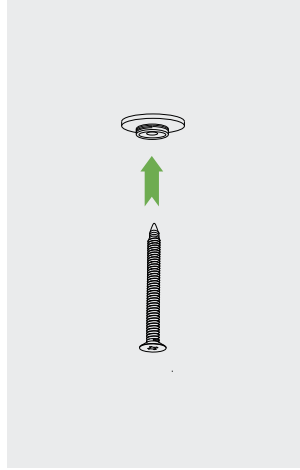

Fig 1. Base Plate

Installation



Step 1.
Unscrew baseplate.



Step 2.
Use appropriate fixing screw to mount base plate (Fig.1).

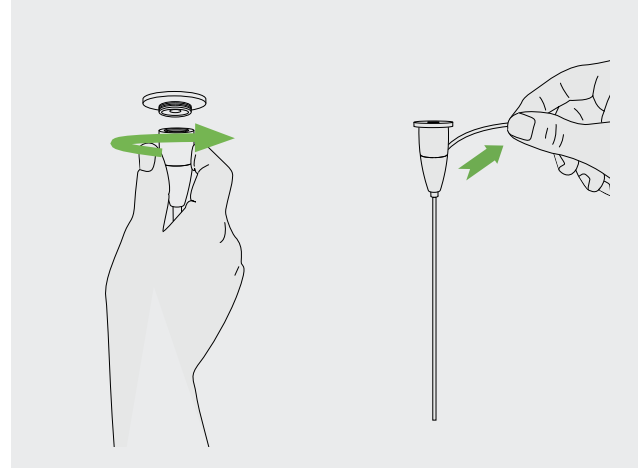

Step 3.
Remove cable from cone. Screw cone back onto baseplate. Re-insert cable and level light. Once desired position is set, trim excess cable.

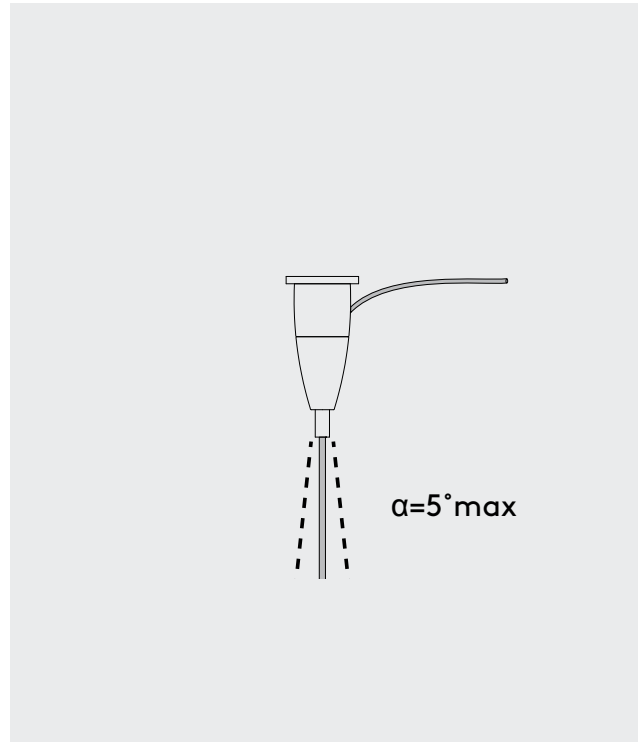
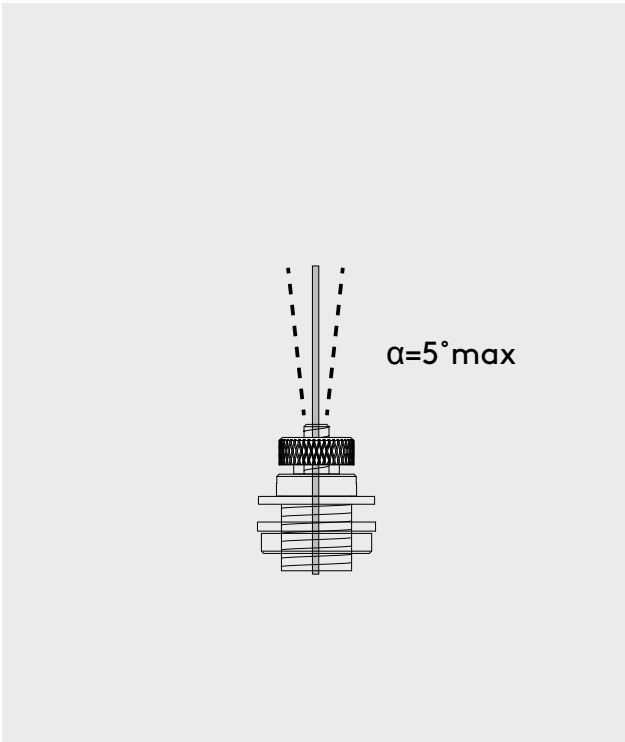

Installation

Small - Driver/Transformer position option 1: Surface mounted in Rakumba canopy

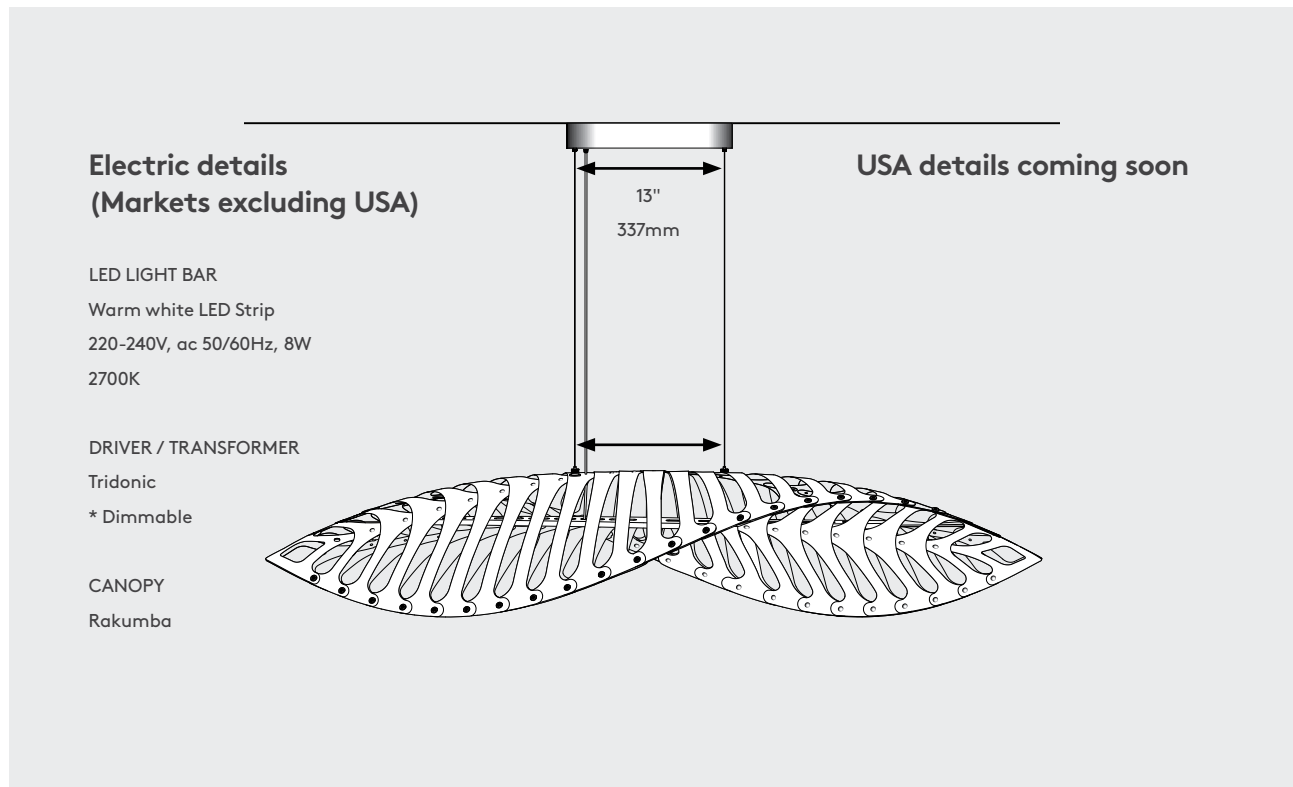

Small - Driver/Transformer position option 2: Hidden in ceiling cavity(not using canopy)

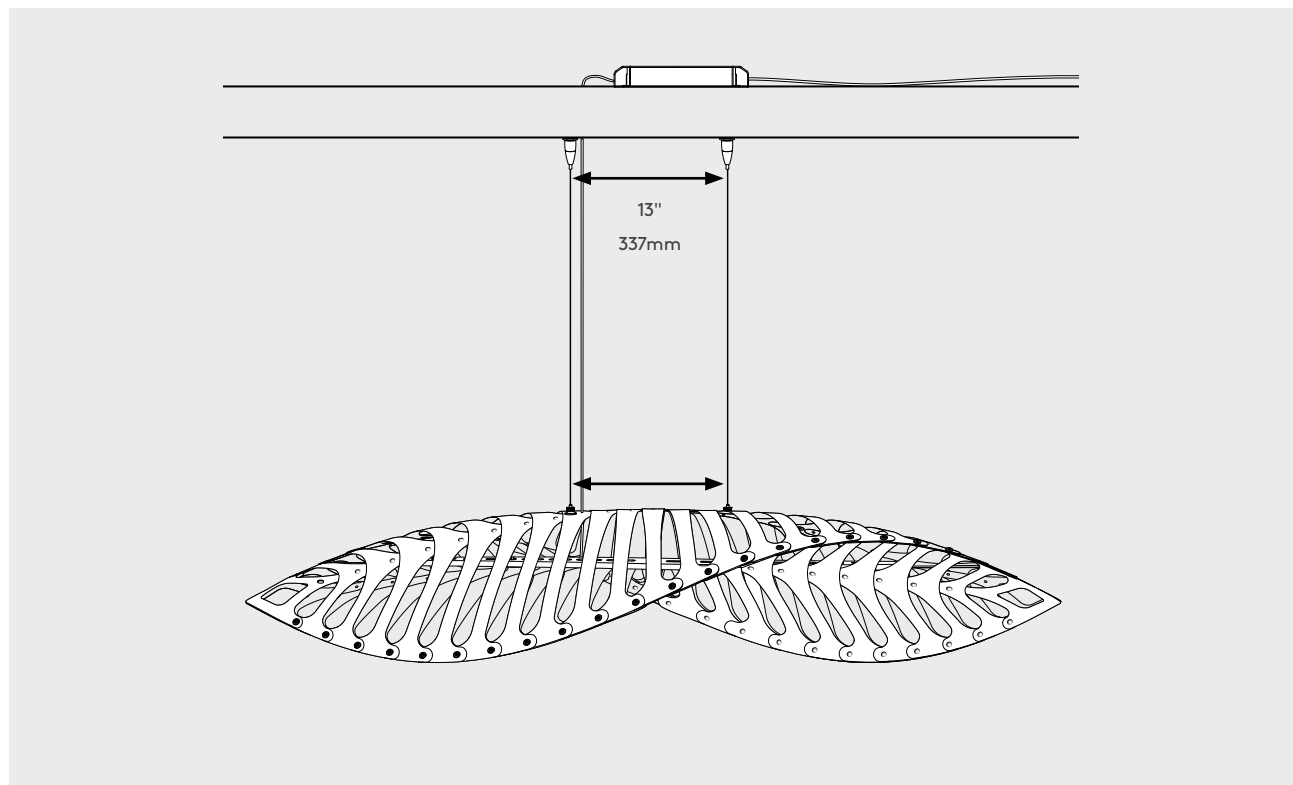

Installation

Medium - Driver/Transformer position option 1: Surface mounted in Rakumba canopy

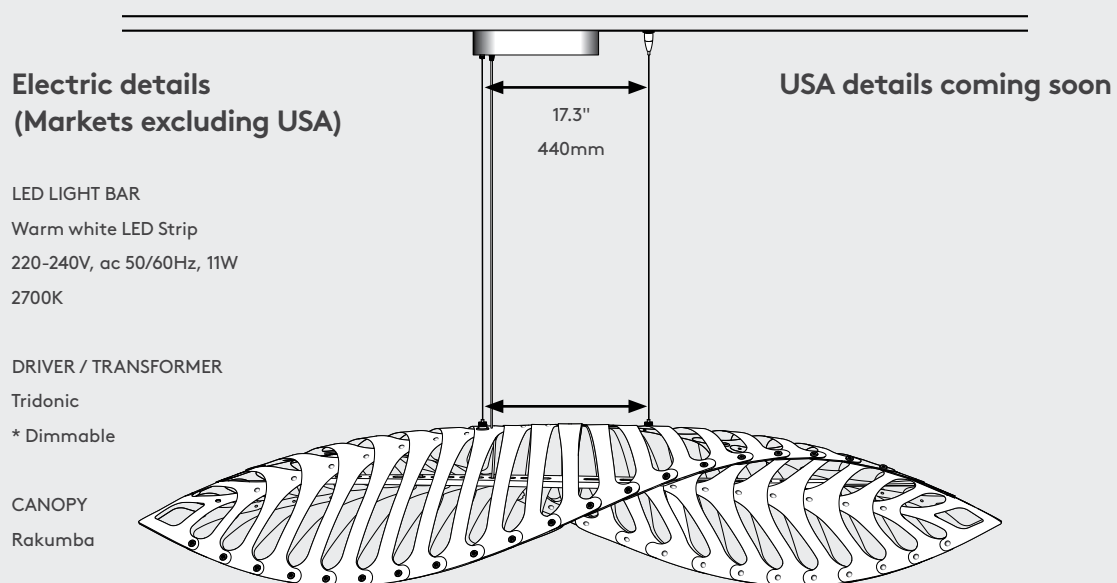

Medium - Driver/Transformer position option 2: Hidden in ceiling cavity(not using canopy)

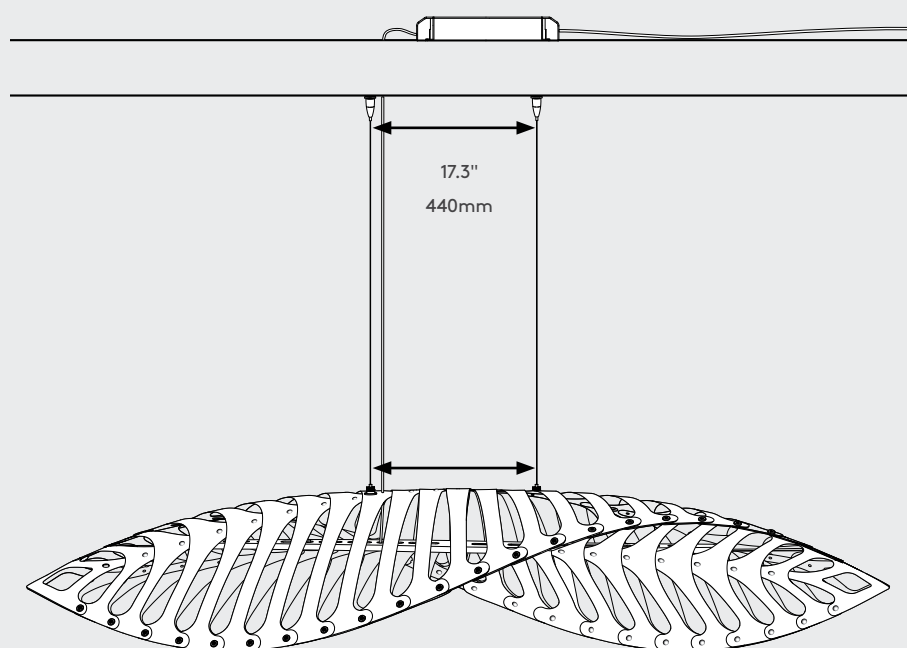

Installation

Large - Driver/Transformer position option 1: Surface mounted in Rakumba canopy

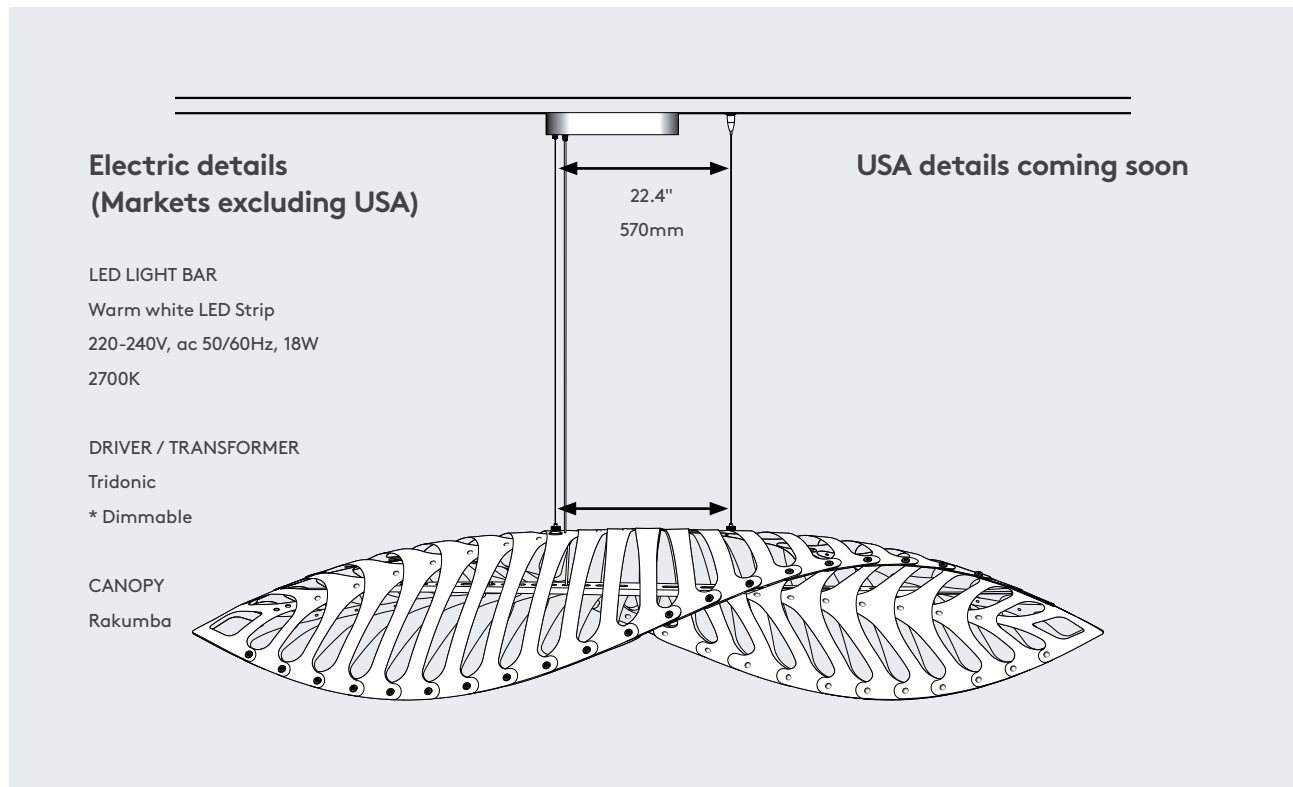

Large - Driver/Transformer position option 2: Hidden in ceiling cavity(not using canopy)

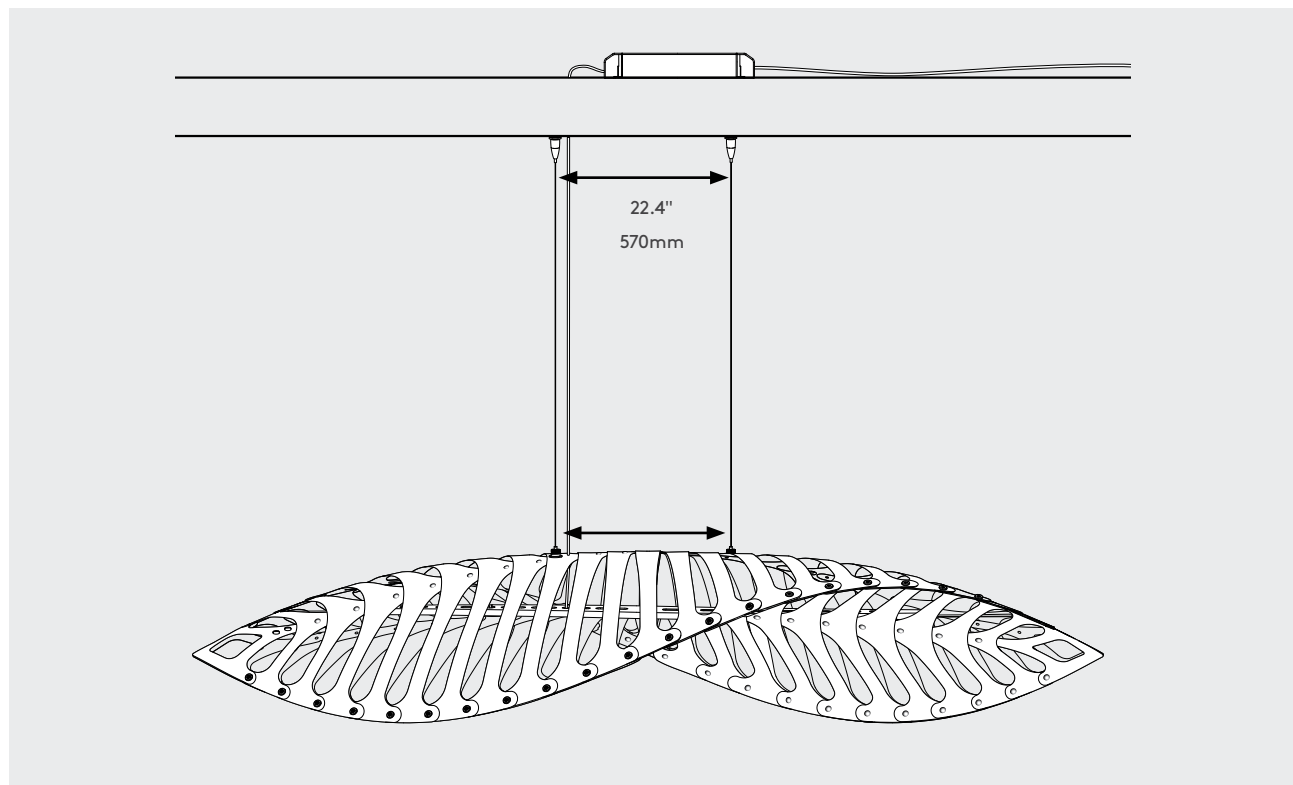

Contact

New Zealand
Showroom/Head office



Contact

+64 6 6500 204
office@davidtrubridge.com

Address

Corner Station Road &
Groome Place, Whakatu,
Hastings, Hawkes Bay,
New Zealand